

PROPOSED FLOOR PLAN.

UPPER BLOCK

- Provide and insert 1 No Reinforced Concrete lintel, 215 mm deep x 100 mm thick bearing 150 mm on each side.
- Provide 1 No New Mirror above Wash hand basin. Size: 640 D x 580 W.
- Stud Wall Construction. 100 x 50 mm s/wood timber studs set at appropriate centres with 1 No sheet of 12.5 mm thick Gyproc wallboard fixed to each side of studs, bonded & skinned.
- 2 No Row, 150 x 150 mm Ceramic Wall tiles above Wash hand basin.

- Block up and insert lintels
- new wheelchair WC
- show
- 150mm cover 25mm
- staff toilet from floor to wall and restate with
- 3 x 470 mm deep.
- construction
- wall tiles
- ins, laid to fall
- to new wash hand

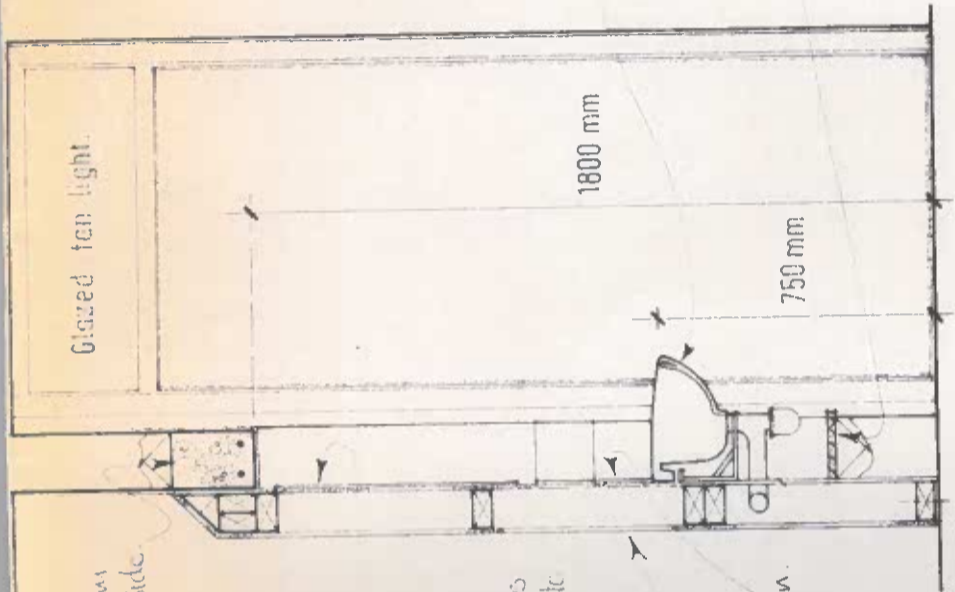

PROPOSED SECTION THROUGH ENTRANCE LOBBY.

GENERAL NOTES

- 100mm thick lightweight concrete block wall plastered both sides with 15mm Sand/Cement plaster.
- 100mm deep floor, Gesta Range, Set in cured skirting.
- Remove existing tiled terrazzo floor finish including floor screed where necessary, to allow for insertion of 215 x 100 mm pre-cast concrete ground/floor beam, reinforced. New Reinforced concrete beam to end bear directly on top of existing concrete block walls over complete width of wall. Damp proof course to be reinstated where disturbed during course of works.

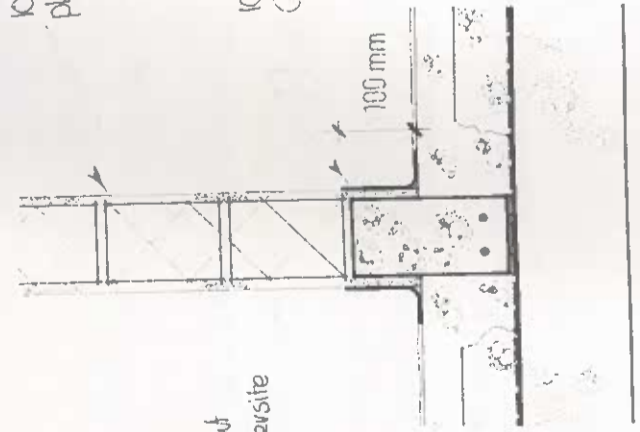

GROUND BEAM DETAIL.

- Form new opening in existing concrete block wall, provide and insert new reinforced concrete lintel. Re-plaster existing concrete block wall where disturbed, including jambs of new opening. Expand angle beads to be fixed to all corners around opening prior to plastering.
- Timber Sola 380, Wall Mounted Wash hand basin complete with Aztec taps.
- Provide and insert 1 No 19mm s/wood shelf, stained and fixed to top of low wall below new washhand basin. Shelf nosing to project 19mm from wall surface, with rounded edge profile.

Electrical installation shall comply with the Regulations for Electrical Installations (IEE Wiring Regulations) Sixteenth Edition with subsequent amendments issued by the Institution of Electrical Engineers.

It is the Contractor's responsibility to visit the site prior to carrying out the proposed works in order to ascertain the full extent of the works involved.

It is the Contractor's responsibility to carry out the works in accordance with all drawings produced by the architect.

project: ST BRECAN'S HIGH SCHOOL, TRENCH RD WATERSIDE, DERRY. DISABLED FACILITIES. scale: 1:10, 1:20 job no.: 9121/05 date: SEPT 95	drawing: PROPOSED PLANS, SECTIONS, ELEVATION'S & DETAIL'S.											
	revised:											
	A											
	B											
	C											
	D											
	E											
	F											
	G											
	H											
	K											
	drawn by: S.H.											
	checked by:											

F M CORR AND ASSOCIATES
 CHARTERED ARCHITECTS
 1, BAYVIEW TERRACE, LONDONDERRY, BT48 7EE
 TEL 261331
 FAX 371985

figured dimensions to be taken in preference to scaled dimensions